

D-3915 *Mpk*

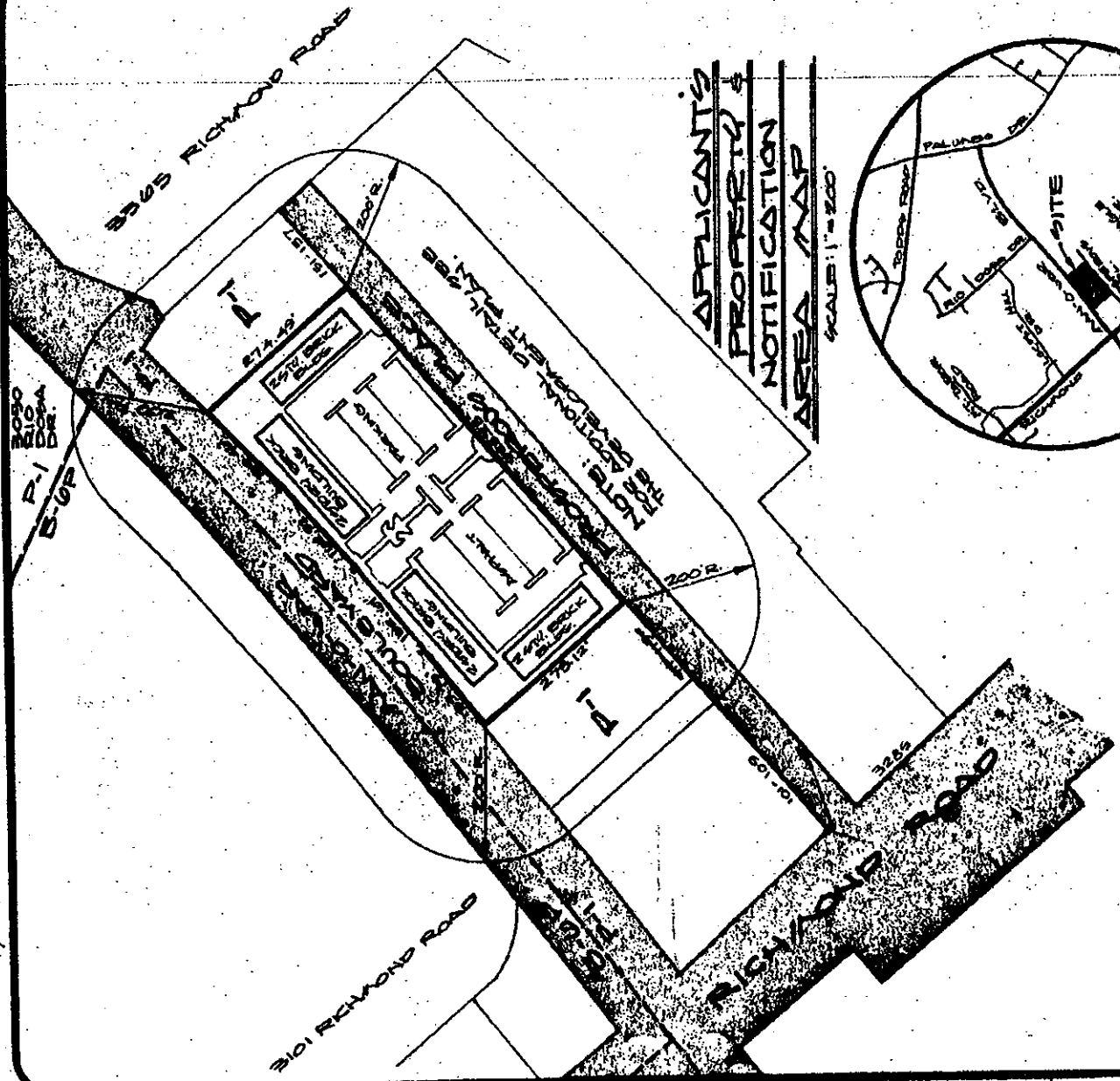

**APPLICANT'S
PROPERTY &
NOTIFICATION
AREA MAP**
SCALE: 1" = 200'

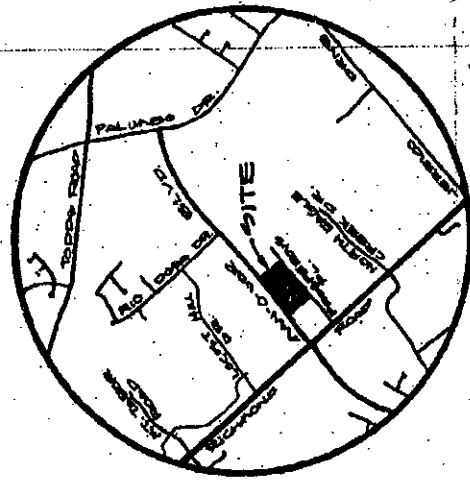

VICINITY MAP
N.T.S.

BOARD OF ADJUSTMENT FLAT FOR
VARIANCE
**RICHMOND SQUARE OFFICE TOWNHOME CONDOMINIUMS COUNCIL
OF CO-OWNERS, INC. AND RICHMOND SQUARE OFFICE
TOWNHOME CONDOMINIUMS COUNCIL OF CO-OWNERS
PHASE III AND IV, INC.**

PROPERTY AT 121, 131, 141
PREVIOUSLY PLACED IN A
PROFESSIONAL OFFICE ZONE (P-1)

IN
**LEXINGTON, FAYETTE
COUNTY, KENTUCKY**
SCALE: 1" = 200'

APRIL 27, 1989

WHEAT & LADENBURGER
138 WEST SHOOT ST., LEXINGTON, KENTUCKY

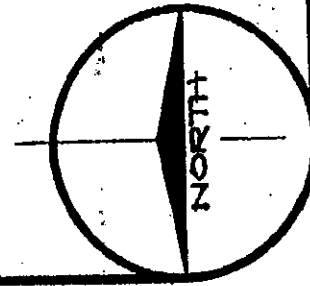

STATE OF KENTUCKY
Roger Ladenerger
\$15
REGISTERED
LAND SURVEYOR